

SPECIFICATION SHEET

# R3450D

3-1/2" Series – Coastal Line



Project \_\_\_\_\_

Notes \_\_\_\_\_

Fixture Type \_\_\_\_\_

Date \_\_\_\_\_

## Low Profile Adjustable Regressed Trim



R3450D-02-QC (illustrated)  
(Lamp not included)

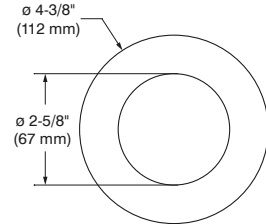
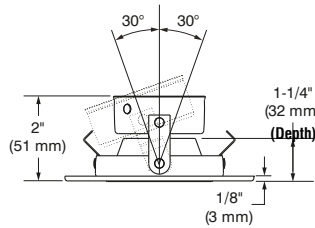

### SPECIFICATIONS

TRIM	Die-formed Stainless Steel.  <b>Different finishes available:</b>  <b>Powder coat painted (Standard)</b> White (-01), Black (-02), Matte White (-11) and Matte Black (-22)
LAMPS (not included)	<b>GU10 LED 10W MAX</b> <b>MR16 GU5.3 37W MAX</b> <b>MR16 LED GU5.3 10W MAX</b>  If you want to use the dimming option and you use a LED lamp, please refer regularly to the lamp manufacturer compatibility list.  For MR16 LED lamp usage, please refer to the selected housing specification sheet for details on transformer models (see compatible housing list below).
CEILING CUTOUT	<b>ø 3-5/8" (92 mm)</b>
ACCESSORIES	<b>Goof Rings</b> (see ordering code) <b>Choice of optional lenses to customize your lighting:</b> (see ordering codes) <b>Clear (C):</b> <b>Frosted (F)</b> <b>Honeycomb (H):</b> the honeycomb louver reduces glare <b>Linear (L):</b> the linear lens directs the lamps beam to create a strip of light <b>Prismatic (P):</b> the prismatic lens diffuses and spreads the light in an even overall pattern <b>Solite (S):</b> the solite lens softens the light in an even overall pattern  <b>Although not dangerous, the use of a 49 mm lens in conjunction with an LED lamp can result in overheating of the latter, reducing its lifespan.</b> <b>Contrast cannot be held responsible for the overheating of LED lamps used with accessory lenses.</b>
CERTIFICATION	cULus for <b>damp locations</b> (for LED and halogens lamps)
WARRANTY	3-year limited warranty

SPECIFICATION SHEET

# R3450D

3-1/2" Series – Coastal Line



## Low Profile Adjustable Regressed Trim



SPECIFICATIONS (CONT'D)

COMPATIBLE HOUSINGS



Remodel Housing

<b>LED</b> 10W	<b>IC / Air Tight</b> RE35GU10-10WQC RE35MR16-120-10WQC RE35MR16-277-10WQC
<b>HALOGENS</b> 37W	<b>Non-IC / Non Air Tight</b> RE35MR16-120-37WQC RE35MR16-277-37WQC

CODIFICATION EXAMPLE

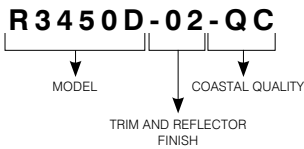

ORDERING CODES

MODEL	TRIM AND REFLECTOR FINISHES	COASTAL QUALITY
<b>R3450D</b>		<b>-QC</b>
<b>R3450D</b>	<b>POWDER COAT PAINTED (Standard)</b>	<b>-QC</b> Coastal Quality
	<b>-01</b> White	
	<b>-02</b> Black	
	<b>-11</b> Matte White	
	<b>-22</b> Matte Black	

GOOF RINGS

Stainless Steel goof rings correct the openings too large or damaged ceiling cutout.



Available in the following finishes : -01, -02, -11 and -22.  
 Add finish color code and **QC** at the end of the goof rings code.  
 Ex.: RON3000-11**QC**

For round trims  
**Code: RON3000**

Outside diameter: ø 6-1/8" (156 mm)  
 Inside diameter: ø 3-5/8" (92 mm)

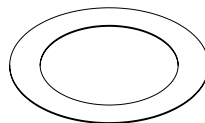

LENSES (49 MM)

For a modification of the light distribution.

- Clear (C): **103104**
- Frosted (F): **304826**
- Honeycomb (H): **103089**
- Linear (L): **103092**
- Prismatic (P): **103095**
- Solite (S): **103098**

