



Concerto

intermezzo

led

PERFORMANCE RECESSED LUMINAIRES FOR RESIDENTIAL AND COMMERCIAL APPLICATIONS



CONTRASTE

Concerto / inTermezzo

Contraste is a leading North American manufacturer of quality lighting products delivering superior, lasting value. We offer a comprehensive range of stylish recessed, pendant and wall mount luminaires, as well as hand-blown decorative glass shades. We are especially well-known for our forgiving installation features and our extensive selection of finishes, providing much appreciated design flexibility to lighting professionals and their customers.

Since 1989, our product line has evolved to comprise several LED luminaire families, including specification-grade Concerto LED, which we are proud to have engineered to our high standards. Our development efforts are customer-focused, future-oriented and environment-friendly. We strive to remain relevant by continually improving the energy efficiency, visual appeal and overall lighting performance of our products. See for yourself.

Concerto

intermezzo



Masterpiece recessed lighting made easy

Like the notes that make up a musical composition, Concerto LED recessed luminaires allow you to create ambience, build rhythm, highlight architectural elements and develop memorable lighting arrangements. But beyond their exciting potential for lighting design, they pack a lot of light for such small, discreet luminaires. All the more reason to let your imagination run free...

An impressive range of instruments

Concerto LED encompasses no less than 17 models of DOWNLIGHTS, ADJUSTABLES and SHOWER LIGHTS. In addition, each trim comes in a wide selection of finishes to match modern decors. The entire product line is designed to meet the highest specification standards.

Value that resonates with everyone

Every luminaire features long lamp life, excellent energy savings and advanced thermal management. Most models provide three lumen outputs to choose from and a variety of color temperatures. Also, Concerto LED driver modules are very compact to facilitate installation and maintenance below the ceiling.

INTERMEZZO

A collection of micro flange pinhole trims compatible with the new construction housings of Concerto series.

CONTENTS

An Inspired Approach to LED Lighting	
The Full Repertoire of LED Benefits	2
Sound LED Technology	2
Proprietary Heatsink Design	3
3-1/2" & 4" Housings and Trims	
Housings and Trims – Overview	4
Housings – Features	6
Housings – How to Order	7
Downlights	
Overview	8
Luminaires	9
Adjustables – Flush & Regressed	
Overview	14
Luminaires	15
Shower Lights	
Overview	20
Luminaires	21
Options & Accessories	24
Photometric Data	27

AN INSPIRED APPROACH TO LED LIGHTING

The Full Repertoire of LED benefits

Concerto and Intermezzo LED are specification-grade recessed luminaires that provide competitive energy savings, long life and reliable performance. In addition, their light-emitting diodes (LEDs) produce light more cost-effectively than conventional source luminaires.

ENERGY SAVINGS

Concerto and Intermezzo LED recessed luminaires use 80% less power than PAR fixtures. Lighting concepts using Concerto and Intermezzo LED deliver lower power densities than most conventional lighting solutions, making them suitable to meet ASHRAE 90.1 and NYSERDA energy codes, and accumulate LEED® points.

LONG LIFE

There are also significant relamping and maintenance savings. Indeed, a Concerto and Intermezzo LED luminaire with integrated lamp typically lasts 50,000 hours (the equivalent of 27 years at 5 hours per day), which is 25 times longer than most halogen PAR lamps.

RELIABLE PERFORMANCE

Concerto and Intermezzo LED recessed luminaires produce more even and effective light distribution than PAR fixtures. In addition to offering an assortment of color temperatures, including 2,700K, 3,000K, 3,500K and 4,000K, they provide excellent color rendering (80 for most luminaires, 90 available in 3,000K models).

Sound LED Technology

- LED modules: Bridgelux VERO 18 (Performance 1 & 2) or CREE CXA2530 (Performance 3)
- 5-year warranty on all LED modules
- Quality Binning:
 - 3-step MacAdam ellipse – within ANSI standards (Performance 1 & 2)
 - 4-step MacAdam ellipse – within ANSI standards (Performance 3)
- Lifespan: 50,000 hours (L₇₀)
- Choice of Performance series 1, 2 and 3 (respectively 16W, 23W and 30W)
- Choice of dimming:
 - 120V only (ELV), Dual Voltage 120V-277V (0-10V)
- Easy maintenance from underneath the ceiling
- Interchangeable optics for fast and easy field modifications

Concerto
intermezzo
led



About LED

- The output of an LED is produced in a single direction while conventional light sources emit light in all directions, resulting in light loss and wasted energy
- Because an LED source is more efficient at converting watts into lumens, fewer luminaires are typically needed in a given area to achieve the desired light levels
- The table below shows the high light output to energy ratio
- LED luminaires with well-controlled optics can deliver a big punch of light as needed. Given their long life, they are ideal for high ceilings and other hard-to-reach spots
- LEDs emit little heat compared to incandescent. However, LEDs are very sensitive to heat, and LED lamps and luminaires last longer when proper heat dissipation is ensured. In enclosed luminaires, such as Concerto and Intermezzo LED, heat management is key to ensuring maximum performance

CONCERTO AND INTERMEZZO LED LIGHTING: LOWER WATTAGE, SAME AMOUNT OF LIGHT

You can tell how bright an incandescent lamp is by its wattage. But with the arrival of LED, watts are a thing of the past. The lumen (lm) is the best gauge of brightness, as it measures light output (or luminous flux) emitted by a source or luminaire. For instance, an 800 lumen output creates mood lighting, no matter what the wattage.

CONCERTO / INTERMEZZO LED					
Performance Options	Luminous Flux (Gross lumens Delivered lumens)		Total Input Watts	Halogen PAR Lamp Equivalent (type watts)	
	Performance 1	1,500 lm		1,100 lm	16W
Performance 2	2,000 lm	1,400 lm	23W	PAR38	80W
Performance 3	2,500 lm	1,700 lm	30W	PAR38	100W

See ordering guides for trims and housings performance compatibilities.

Proprietary Heatsink Design

In keeping with its pledge to continually improve product performance, Contrast has revamped the thermal management of its Concerto and Intermezzo LED recessed luminaires. In fact, our engineers have completely redesigned the two aluminum heatsinks used by Concerto and Intermezzo LED.



Leaning tower of performance
Adjustable trims come with a 'Pisa Tower' style heatsink to provide 30° adjustability for 3-1/2" trims and 40° aiming for 4" trims.



A fin method for heat dispersal
Downlight and shower trims feature a turbine-styled heatsink.

Information on Trim-Housing Compatibility

Trims incorporate an LED chip, but the LED driver in the housing is what actually determines the lumen output of a luminaire. That being said, Performance 2 trims are compatible with Performance 1 and Performance 2 housings, depending on the lumen output required for the task. Performance 3 trims include a different LED chip that is only compatible with Performance 3 housings.

3-1/2" & 4" HOUSINGS

REMODELERS NON-IC

Non-IC remodeler housings are offered in Performance 1 and 2 (16W and 23W) for downlight, adjustable and shower light trims. Compatible with all two dimming options (ELV and 0-10V). Choice of mounting plates, extendable mounting bars and other accessories (see pages 24-26).

- RELD300 – 3-1/2"
- RELD200 – 4"



NEW CONSTRUCTION NON-IC

Non-IC new construction housings are offered in Performance 1, 2 and 3 (16W, 23W and 30W) for downlights, and in Performance 1 and 2 for adjustable and shower light trims. Compatible with all two dimming options (ELV and 0-10V). ELV available only in performance 1 and 2.

- NWLD300 – 3-1/2"
- NWLD200 – 4"



CLASSIC NEW CONSTRUCTION (IC)

Insulated ceiling housings are offered in Performance 1 and 2 (16W and 23W) for downlight and shower light trims. Adjustable trims are only offered in Performance 1 for insulated ceilings. Chicago Plenum option available. Compatible with all two dimming options (ELV and 0-10V).

- ISLD300 – 3-1/2"
- ISLD200 – 4"



Note: See page 6 and 7 for ordering codes



3-1/2" & 4" TRIMS

STYLES

Downlights

- 3-1/2" – LD3D, LD3E, LD3F, LD3G
- 4" – LD2J, LD2K, INT20PR, INT21PR

Adjustables – Flush and Regressed

- 3-1/2" – LD3A, LD3B
- 4" – LD2A, LD2B, LD2D, LD2E, INT20PA, INT21PA

Shower Lights

- 3-1/2" – LD3C, LD3H, LD3I
- 4" – LD2C, LD2F



LD3DC-12BR (Illustrated)

REFLECTORS

CONCERTO, available on downlights and regressed adjustables.
INTERMEZZO, reflectors are painted black for a discrete look in your ceiling.

See page 24 (Options and Accessories) for more details

LENSES

CONCERTO, six lens options are available on 4" and 3-1/2" downlight and adjustables (Except "spot" options). Shower lights come with three lens choices.
INTERMEZZO, clear lens provided with trims, no replacement lenses available.

See page 24 (Options and Accessories) for more details

FINISHES

Available on most of Concerto and Intermezzo LED recessed luminaires.

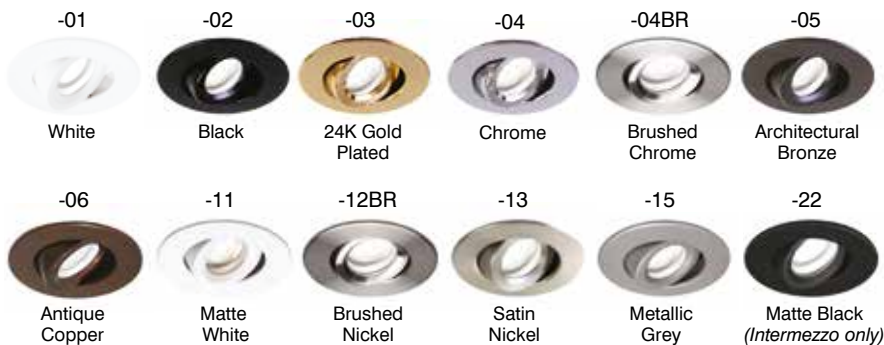

3-1/2" & 4" HOUSINGS – FEATURES

At **Contraste**, we have built our reputation on superior craftsmanship and installation friendly luminaires. As a result, **Concerto** and **Intermezzo** LED housings feature high quality materials and they are designed for long service life. In addition, they are very forgiving when it comes to installation, which allows considerable time savings.

Features common to all three housing types

- Galvanized 18-gauge steel construction
- Housings accessible below the ceiling for easy maintenance
- Suited to ceiling thicknesses up to 1-1/2"
- Hole cutouts: 3-5/8" and 4-1/4" diameter
- Perfect fit to ceiling, no light leakage
- Dimming options: 120V only (ELV), Dual Voltage 120V-277V (0-10V)
- Efficiencies up to 80 LPW, well beyond Energy Star requirements (55 LPW)
- Listed cULus (E343977)
- Junction box supports up to 10 14-gauge wires or 8 12-gauge wires (90°C wires)
- Mounting bars extend from 10" (254 mm) to 24-1/2" (622 mm) to fit most ceiling structures
- Remodeler NON-IC: Patented hook (PAT#CAN2,088,648 and USA 5,377,088) for ease of installation and perfect fit to ceiling
- Classic New Construction IC Housings:
 - Aluminum components for better thermal management
 - Available option to meet Chicago Plenum requirements



3-1/2" & 4" HOUSINGS – HOW TO ORDER

A complete order includes a code for the trim and another for the housing. Trim ordering codes are provided on product pages 8 through 23. Housing ordering codes are as follows:

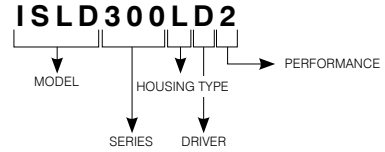

ORDERING CODES

MODEL	SERIES	HOUSING TYPE	DRIVER	PERFORMANCE	COMPLIANCE OPTION
RELD Remodel NON-IC Housing	200 200 Series, 4"	L Long	V* ELV (only 120V)	1 16W	... Standard
NWLD New Construction NON-IC Housing	300 300 Series, 3-1/2"		D 0-10V — Dual Voltage (120V / 277V)	2 23W	X Chicago Plenum
ISLD Classic New Construction IC Housing				3* 30W	Available only for Classic New Construction IC Housing

*Available only in Performance 1 and 2

*Available only for New Construction NON-IC Housing

* Performance 1 and 2 housings are compatible with performance 2 trims.
 Performance 3 housings are only compatible with performance 3 trims.

REMODEL NON-IC – 3-1/2"

- RELD300LD1
- RELD300LD2
- RELD300LV1
- RELD300LV2

REMODEL NON-IC – 4"

- RELD200LD1
- RELD200LD2
- RELD200LV1
- RELD200LV2



NEW CONSTRUCTION NON-IC – 3-1/2"

- NWLD300LD1
- NWLD300LD2
- NWLD300LD3
- NWLD300LV1
- NWLD300LV2

NEW CONSTRUCTION NON-IC – 4"

- NWLD200LD1
- NWLD200LD2
- NWLD200LD3
- NWLD200LV1
- NWLD200LV2



CLASSIC NEW CONSTRUCTION IC – 3-1/2"

- ISLD300LD1
- ISLD300LD2
- ISLD300LV1
- ISLD300LV2

CLASSIC NEW CONSTRUCTION IC – 4"

- ISLD200LD1
- ISLD200LD2
- ISLD200LV1
- ISLD200LV2

- ISLD300LD1X
- ISLD300LD2X
- ISLD300LV1X
- ISLD300LV2X

- ISLD200LD1X
- ISLD200LD2X
- ISLD200LV1X
- ISLD200LV2X



INTERMEZZO, Compatible only with new construction NON-IC housing 4" series.

Visit Contraste Website for a suggested compatible dimmers list or for more details (www.contrastlighting.com).

Downlights

The Concerto and Intermezzo LED Downlight family has grown, offering two new 4" trims ideally suited to higher ceilings and applications requiring a bigger punch of light. With the extensive selection of finishes available for each trim, not to mention the color, beam, reflector and output options to choose from, specifiers have an endless palette of luminaires and decorative possibilities at their disposal.

Features

- Four 3-1/2" models and four 4" trims to choose from
- Variety of reflector styles, including anodized aluminum, specular and painted reflectors
- Beam pattern flexibility lets you choose from Spot, Narrow Flood and Flood
- Choice of interchangeable lenses and reflectors for future on-site modifications
- Ultrathin protection lens (3 mm) covered with high-performance film (98% light transmission)
- Available color options: 2,700K, 3,000K, 3,500K, 4,000K
- Excellent color rendering: 80+ CRI on all models (90+ CRI available in 3,000K models)
- Choice of Performance options. Performance 2 trims work with either Performance 1 (16W) or Performance 2 (23W) housings. Performance 3 trims works only with performance 3 housings (30W).
– See ordering codes for details.
- All models (except Intermezzo) compatible with Remodeler NON-IC, New Construction NON-IC and Classic New Construction IC housings
- Luminaire/Photometric evaluations and listings: cULus, RoHS
- Warranties: 1 year on standard finishes and 5 years on LED modules and drivers



LD3D Low Profile Round Regressed Trim

Downlights

3-1/2"

For photometric data, see page 28



LD3DC-02CL (Illustrated)

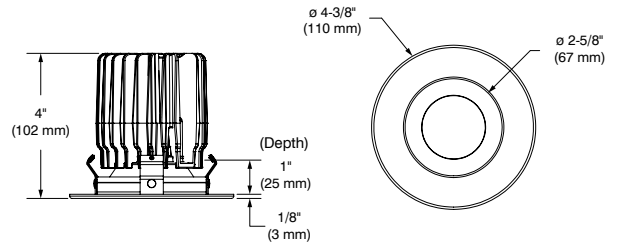

ORDERING CODES

Ex.: LD3DC-01012780M2

MODEL	LENS	FINISHES	REFLECTORS	COLOR TEMPERATURE	CRI	BEAMS	PERFORMANCE
LD3D							
LD3D	C Clear	-01 White	ANODIZED	27 2,700K	80 80+ CRI	M Narrow Flood (33°)	2
	F Frosted	-02 Black	AN Anodized Aluminum	30 3,000K	90 90+ CRI		
	H Honeycomb	-03 24K Gold Plated		35 3,500K		W Flood (48°)	3
	L Linear	-04 Chrome	SPECULAR	40 4,000K			
	P Prismatic	-04BR Brushed Chrome	CL Clear		Only with 3,000K		
	S Solite	-05 Architectural Bronze	BK Black				
		-06 Antique Copper					
		-11 Matte White	PAINTED				
		-12BR Brushed Nickel	01 White*				
		-13 Satin Nickel	02 Black				
		-15 Metallic Grey	05 Architectural Bronze*				
			06 Antique Copper*				
			11 Matte White*				
			15 Metallic Grey*				

Use with Performance 1 or Performance 2 Housings

*These reflector colors are available only with the same trim color.

LD3E Low Profile Round Regressed Trim with Lipped Reflector

For photometric data, see page 28



LD3EC-11AN (Illustrated)



LD3EC-13CL (Illustrated)
Spot Beam

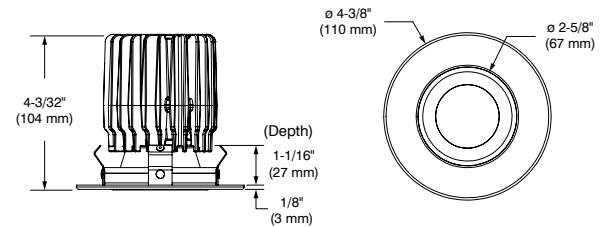

ORDERING CODES

Ex.: LD3EC-02CL2780S2

MODEL	LENS	FINISHES	REFLECTORS	COLOR TEMPERATURE	CRI	BEAMS	PERFORMANCE
LD3E							
LD3E	C Clear	-01 White	ANODIZED	27 2,700K	80 80+ CRI	S Spot (21°)	2
	F Frosted	-02 Black	AN Anodized Aluminum	30 3,000K	90 90+ CRI	M Narrow Flood (26°)	3
	H Honeycomb	-03 24K Gold Plated		35 3,500K			
	L Linear	-04 Chrome	SPECULAR	40 4,000K	Only with 3,000K		
	P Prismatic	-04BR Brushed Chrome	CL Clear				
	S Solite	-05 Architectural Bronze	BK Black				
		-06 Antique Copper					
		-11 Matte White	PAINTED				
		-12BR Brushed Nickel	01 White*				
		-13 Satin Nickel	02 Black				
		-15 Metallic Grey	05 Architectural Bronze*				
			06 Antique Copper*				
			11 Matte White*				
			15 Metallic Grey*				

Use with Performance 1 or Performance 2 Housings

Spot is only offered with specular clear reflector (CL) and clear lens (C).

*These reflector colors are available only with the same trim color.

LD3F Square Regressed Low Profile Trim with Lipped Reflector

Downlights **3-1/2"**

For photometric data, see page 29



LD3FC-02AN (Illustrated)



LD3FC-06CL (Illustrated)
Spot Beam

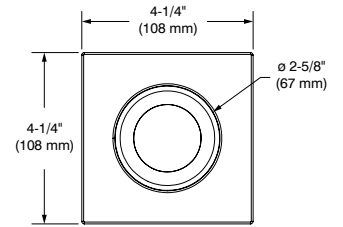
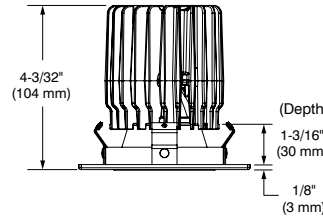

ORDERING CODES

Ex.: LD3FC-01AN2780M2

MODEL	LENS	FINISHES	REFLECTORS	COLOR TEMPERATURE	CRI	BEAMS	PERFORMANCE
LD3F							
LD3F	C Clear	-01 White	ANODIZED	27 2,700K	80 80+ CRI	S Spot (21°)	2
	F Frosted	-02 Black	AN Anodized Aluminum	30 3,000K	90 90+ CRI	M Narrow Flood (26°)	3
	H Honeycomb	-03 24K Gold Plated		35 3,500K	Only with 3,000K		
	L Linear	-04 Chrome	SPECULAR	40 4,000K			
	P Prismatic	-04BR Brushed Chrome	CL Clear				
	S Solite	-05 Architectural Bronze	BK Black				
		-06 Antique Copper	PAINTED				
		-11 Matte White	01 White*				
		-12BR Brushed Nickel	02 Black				
		-13 Satin Nickel	05 Architectural Bronze*				
		-15 Metallic Grey	06 Antique Copper*				
			11 Matte White*				
			15 Metallic Grey*				

Use with Performance 1 or Performance 2 Housings

Spot is only offered with specular clear reflector (CL) and clear lens (C).

*These reflector colors are available only with the same trim color.

LD3G Square Regressed Low Profile Trim with Square Pinhole

For photometric data, see page 29



LD3GC-04BK (Illustrated)

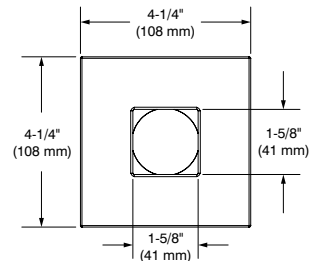
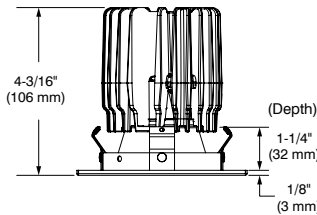

ORDERING CODES

Ex.: LD3GC-11114080M2

MODEL	LENS	FINISHES	REFLECTORS	COLOR TEMPERATURE	CRI	BEAM	PERFORMANCE
LD3G						M	2
LD3G	C Clear	-01 White	ANODIZED	27 2,700K	80 80+ CRI	M Narrow Flood (33°)	2
	F Frosted	-02 Black	AN Anodized Aluminum	30 3,000K	90 90+ CRI		
	H Honeycomb	-03 24K Gold Plated		35 3,500K	Only with 3,000K		
	L Linear	-04 Chrome	SPECULAR	40 4,000K			
	P Prismatic	-04BR Brushed Chrome	CL Clear				
	S Solite	-05 Architectural Bronze	BK Black				
		-06 Antique Copper	PAINTED				
		-11 Matte White	01 White*				
		-12BR Brushed Nickel	02 Black				
		-13 Satin Nickel	05 Architectural Bronze*				
		-15 Metallic Grey	06 Antique Copper*				
			11 Matte White*				
			15 Metallic Grey*				

Use with Performance 1 or Performance 2 Housings

*These reflector colors are available only with the same trim color.

LD2J Low Profile Round Regressed Trim

Downlights

4"

For photometric data, see page 29



LD2JC-05AN (Illustrated)

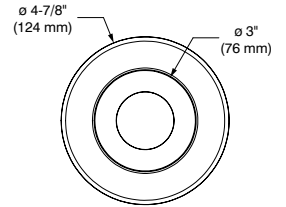
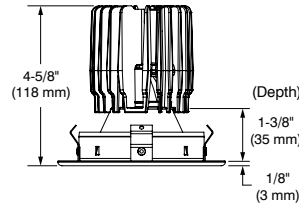

ORDERING CODES

Ex.: LD2JC-01012780M

MODEL	LENS	FINISHES	REFLECTORS	COLOR TEMPERATURE	CRI	BEAMS	PERFORMANCE
LD2J							
LD2J	C Clear	-01 White	ANODIZED	27 2,700K	80 80+ CRI	M Narrow	2
	F Frosted	-02 Black	AN Anodized Aluminum	30 3,000K	90 90+ CRI	Flood (33°)	3
	H Honeycomb	-03 24K Gold Plated		35 3,500K		W Flood (48°)	
	L Linear	-04 Chrome	SPECULAR	40 4,000K			
	P Prismatic	-04BR Brushed Chrome	CL Clear		Only with 3,000K		
	S Solite	-05 Architectural Bronze	BK Black				
		-06 Antique Copper	PAINTED				
		-11 Matte White	01 White*				
		-12BR Brushed Nickel	02 Black				
		-13 Satin Nickel	05 Architectural Bronze*				
		-15 Metallic Grey	06 Antique Copper*				
			11 Matte White*				
			15 Metallic Grey*				

Use with Performance 1 or Performance 2 Housings

*These reflector colors are available only with the same trim color.

LD2K Low Profile Square Regressed Trim

For photometric data, see page 29



LD2KC-12BRBK (Illustrated)

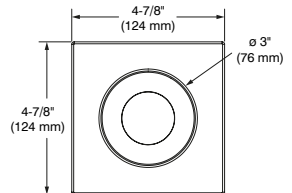
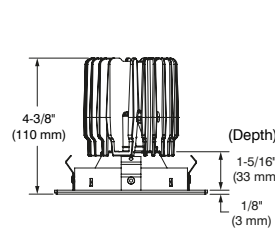

ORDERING CODES

Ex.: LD2JC-01012780M2

MODEL	LENS	FINISHES	REFLECTORS	COLOR TEMPERATURE	CRI	BEAMS	PERFORMANCE
LD2K							
LD2K	C Clear	-01 White	ANODIZED	27 2,700K	80 80+ CRI	M Narrow	2
	F Frosted	-02 Black	AN Anodized Aluminum	30 3,000K	90 90+ CRI	Flood (33°)	3
	H Honeycomb	-03 24K Gold Plated		35 3,500K		W Flood (48°)	
	L Linear	-04 Chrome	SPECULAR	40 4,000K			
	P Prismatic	-04BR Brushed Chrome	CL Clear		Only with 3,000K		
	S Solite	-05 Architectural Bronze	BK Black				
		-06 Antique Copper	PAINTED				
		-11 Matte White	01 White*				
		-12BR Brushed Nickel	02 Black				
		-13 Satin Nickel	05 Architectural Bronze*				
		-15 Metallic Grey	06 Antique Copper*				
			11 Matte White*				
			15 Metallic Grey*				

Use with Performance 1 or Performance 2 Housings

*These reflector colors are available only with the same trim color.

INT20PR Ultra-Thin Profile Round Downlight Regressed Trim with Pinhole Aperture



INT20PR-11 (Illustrated)

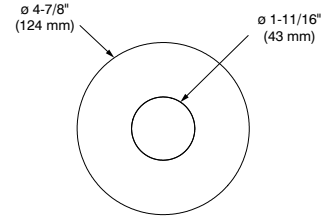
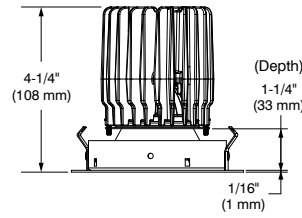

ORDERING CODES

Ex.: INT20PR-1127M

MODEL	TYPE	TRIM FINISHES	COLOR TEMPERATURES	BEAM	
INT20	PR			M	
INT20	Intermezzo round	PR Downlight Pinhole	-11 Matte White -12BR Brushed Nickel -22 Matte Black	27 2,700K 30 3,000K 35 3,500K 40 4,000K	M Narrow Flood (35°)

INT21PR Ultra-Thin Profile Square Downlight Regressed Trim with Pinhole Aperture



INT21PR-11 (Illustrated)

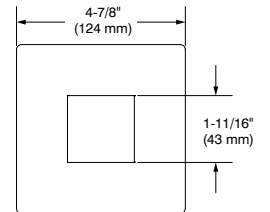
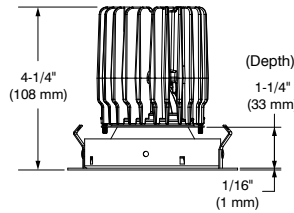

ORDERING CODES

Ex.: INT21PR-2240M

MODEL	TYPE	TRIM FINISHES	COLOR TEMPERATURES	BEAM	
INT21	PR			M	
INT21	Intermezzo square	PR Downlight Pinhole	-11 Matte White -12BR Brushed Nickel -22 Matte Black	27 2,700K 30 3,000K 35 3,500K 40 4,000K	M Narrow Flood (35°)



Adjustables

Concerto and Intermezzo LED Adjustables now feature 359° rotation for improved aiming. Also, they offer more aiming flexibility, given the superior tilting range of Contraste's very own "Pisa tower" heatsink design. With the extensive selection of finishes available for each trim, not to mention the color, beam, reflector and output options to choose from, specifiers have an endless palette of luminaires and decorative possibilities at their disposal.

Features

- Adjustables include four regressed and two flush 4" trims, as well as two 3-1/2" flush models
- Improved aiming adjustability: 30° tilt with 3-1/2" trims and 40° tilt with 4" models
- Added rotation flexibility: trims turn 359° for optimal aiming
- Lockable aiming on all trims
- Regressed models come with a variety of reflector styles, including anodized aluminum, specular and painted reflectors. Intermezzo, black painted reflector only.
- Beam pattern flexibility lets you choose from Narrow Flood and Flood
- Choice of interchangeable lenses and reflectors for future on-site modifications
- Ultra-Thin protection lens (3 mm) covered with high-performance film (98% light transmission)
- Available color options: 2700K, 3000K, 3500K and 4000K
- Excellent color rendering: 80+ CRI on all models (90+ CRI available in 3,000K models)
- Choice of Performance options. Performance 2 trims work with either performance 1 (16W) or Performance 2 (23W) housings.
– See ordering codes for more details
- All models (except Intermezzo) compatible with Remodeler NON-IC, New Construction NON-IC and Classic New Construction IC housings available only in Performance 1 for Adjustable trims
- Luminaire/Photometric evaluations and listings: cULus, RoHS
- Warranties: 1 year on standard finishes and 5 years on LED modules and drivers



LD3A Low Profile Round Adjustable Trim

Adjustables

3-1/2"

For photometric data, see page 30



LD3AC-03 (Illustrated)

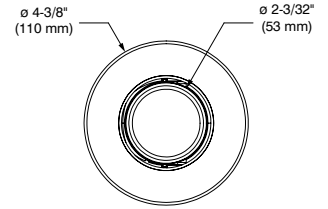
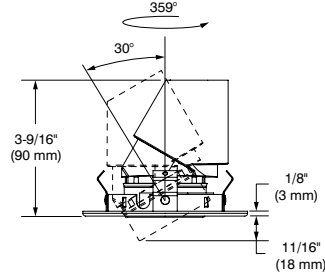

ORDERING CODES

Ex.: LD3AC-113580W2

MODEL	LENS	FINISHES	COLOR TEMPERATURE	CRI	BEAMS	PERFORMANCE
LD3A						2
LD3A	C Clear	-01 White	27 2,700K	80 80 + CRI	M Narrow Flood (27°)	2 Use with Performance 1 or Performance 2 Housings
	F Frosted	-02 Black	30 3,000K	90 90 + CRI	W Flood (47°)	
	H Honeycomb	-03 24K Gold Plated	35 3,500K			
	L Linear	-04 Chrome	40 4,000K	Only with 3,000K		
	P Prismatic	-04BR Brushed Chrome				
	S Solite	-05 Architectural Bronze				
		-06 Antique Copper				
		-11 Matte White				
		-12BR Brushed Nickel				
		-13 Satin Nickel				
		-15 Metallic Grey				

LD3B Low Profile Square Adjustable Trim

For photometric data, see page 30



LD3BC-04BR (Illustrated)

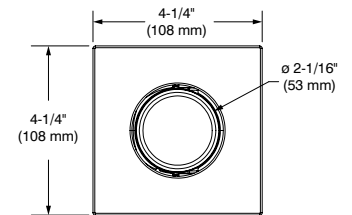
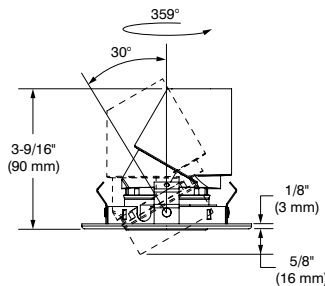

ORDERING CODES

Ex.: LD3BC-153090M2

MODEL	LENS	FINISHES	COLOR TEMPERATURE	CRI	BEAMS	PERFORMANCE
LD3B						2
LD3B	C Clear	-01 White	27 2,700K	80 80 + CRI	M Narrow Flood (27°)	2 Use with Performance 1 or Performance 2 Housings
	F Frosted	-02 Black	30 3,000K	90 90 + CRI	W Flood (47°)	
	H Honeycomb	-03 24K Gold Plated	35 3,500K			
	L Linear	-04 Chrome	40 4,000K	Only with 3,000K		
	P Prismatic	-04BR Brushed Chrome				
	S Solite	-05 Architectural Bronze				
		-06 Antique Copper				
		-11 Matte White				
		-12BR Brushed Nickel				
		-13 Satin Nickel				
		-15 Metallic Grey				

LD2A Low Profile Round Adjustable Trim

Adjustables

4"

For photometric data, see page 30



LD2AC-01 (Illustrated)

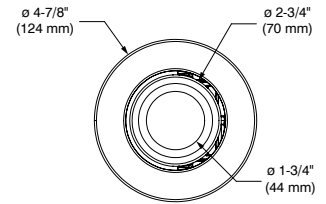
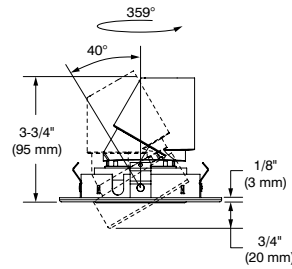

ORDERING CODES

Ex.: LD2AC-014080M2

MODEL	LENS	FINISHES	COLOR TEMPERATURE	CRI	BEAMS	PERFORMANCE
LD2A						2
LD2A	C Clear	-01 White	27 2,700K	80 80 + CRI	M Narrow Flood (27°)	2 Use with Performance 1 or Performance 2 Housings
	F Frosted	-02 Black	30 3,000K	90 90 + CRI	W Flood (47°)	
	H Honeycomb	-03 24K Gold Plated	35 3,500K	Only with 3,000K		
	L Linear	-04 Chrome	40 4,000K			
	P Prismatic	-04BR Brushed Chrome				
	S Solite	-05 Architectural Bronze				
		-06 Antique Copper				
		-11 Matte White				
		-12BR Brushed Nickel				
		-13 Satin Nickel				
		-15 Metallic Grey				

LD2B Low Profile Square Adjustable Trim

For photometric data, see page 30



LD2BC-02 (Illustrated)

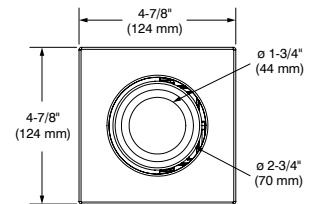
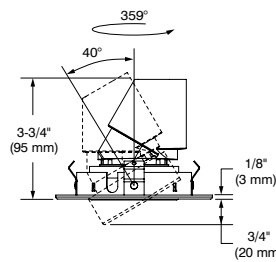

ORDERING CODES

Ex.: LD2BC-024080M2

MODEL	LENS	FINISHES	COLOR TEMPERATURE	CRI	BEAMS	PERFORMANCE
LD2B						2
LD2B	C Clear	-01 White	27 2,700K	80 80 + CRI	M Narrow Flood (27°)	2 Use with Performance 1 or Performance 2 Housings
	F Frosted	-02 Black	30 3,000K	90 90 + CRI	W Flood (47°)	
	H Honeycomb	-03 24K Gold Plated	35 3,500K	Only with 3,000K		
	L Linear	-04 Chrome	40 4,000K			
	P Prismatic	-04BR Brushed Chrome				
	S Solite	-05 Architectural Bronze				
		-06 Antique Copper				
		-11 Matte White				
		-12BR Brushed Nickel				
		-13 Satin Nickel				
		-15 Metallic Grey				

LD2D Low Profile Round Adjustable Regressed Trim

Adjustables

4"

For photometric data, see page 31



LD2DC-13SP (Illustrated)

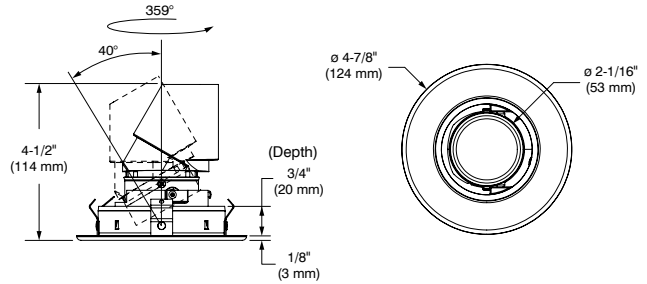

ORDERING CODES

EX.: LD2DC-02SP2780M2

MODEL	LENS	FINISHES	REFLECTORS	COLOR TEMPERATURE	CRI	BEAMS	PERFORMANCE
LD2D							2
LD2D	C Clear	-01 White	ANODIZED	27 2,700K	80 80 + CRI	M Narrow Flood (27°)	2
	F Frosted	-02 Black	AN Anodized	30 3,000K	90 90 + CRI	W Flood (48°)	
	H Honeycomb	-03 24K Gold Plated	Aluminum	35 3,500K	Only with 3,000K		
	L Linear	-04 Chrome		40 4,000K			
	P Prismatic	-04BR Brushed Chrome	SPECULAR				
	S Solite	-05 Architectural Bronze	SP Specular				
		-06 Antique Copper	PAINTED			Use with Performance 1 or Performance 2 Housings	
		-11 Matte White	01 White*				
		-12BR Brushed Nickel	02 Black				
		-13 Satin Nickel	05 Architectural Bronze*				
		-15 Metallic Grey	06 Antique Copper*				
			11 Matte White*				
			15 Metallic Grey*				

*These reflector colors are available only with the same trim color.

LD2E Low Profile Square Adjustable Regressed Trim

For photometric data, see page 31



LD2EC-06SP (Illustrated)

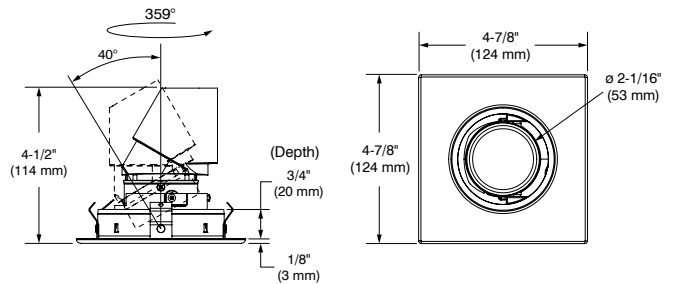

ORDERING CODES

EX.: LD2EC-06062780M2

MODEL	LENS	FINISHES	REFLECTORS	COLOR TEMPERATURE	CRI	BEAMS	PERFORMANCE
LD2E							2
LD2E	C Clear	-01 White	ANODIZED	27 2,700K	80 80 + CRI	M Narrow Flood (27°)	2
	F Frosted	-02 Black	AN Anodized	30 3,000K	90 90 + CRI	W Flood (48°)	
	H Honeycomb	-03 24K Gold Plated	Aluminum	35 3,500K	Only with 3,000K		
	L Linear	-04 Chrome		40 4,000K			
	P Prismatic	-04BR Brushed Chrome	SPECULAR				
	S Solite	-05 Architectural Bronze	SP Specular				
		-06 Antique Copper	PAINTED			Use with Performance 1 or Performance 2 Housings	
		-11 Matte White	01 White*				
		-12BR Brushed Nickel	02 Black				
		-13 Satin Nickel	05 Architectural Bronze*				
		-15 Metallic Grey	06 Antique Copper*				
			11 Matte White*				
			15 Metallic Grey*				

*These reflector colors are available only with the same trim color.

INT20PA Ultra-Thin Profile Round Adjustable Regressed Trim with Pinhole Aperture

Adjustables

4"



INT20PA-11 (Illustrated)

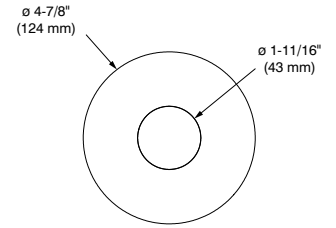
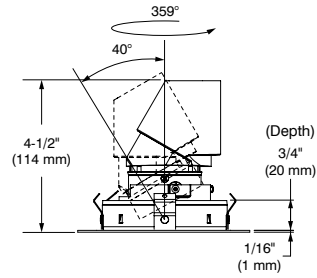

ORDERING CODES

Ex.: INT20PA-1127M

MODEL	TYPE	TRIM FINISHES	COLOR TEMPERATURES	BEAM
INT20	PA			M
Intermezzo round	Adjustable Pinhole	-11 Matte White -12BR Brushed Nickel -22 Matte Black	27 2,700K 30 3,000K 35 3,500K 40 4,000K	M Narrow Flood (35°)

INT21PA Ultra-Thin Profile Square Adjustable Regressed Trim with Pinhole Aperture



INT21PA-22 (Illustrated)

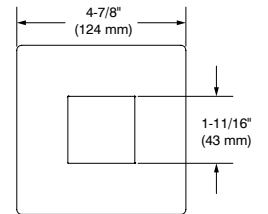
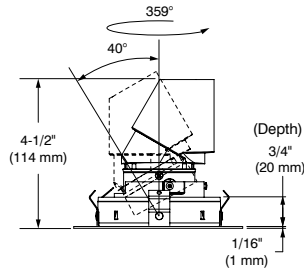

ORDERING CODES

Ex.: INT21PA-2235M

MODEL	TYPE	TRIM FINISHES	COLOR TEMPERATURES	BEAM
INT21	PA			M
Intermezzo square	Adjustable Pinhole	-11 Matte White -12BR Brushed Nickel -22 Matte Black	27 2,700K 30 3,000K 35 3,500K 40 4,000K	M Narrow Flood (35°)

ra Muji

Mura Muji

MACADA
DESIGN

MACADA
DESIGN



Showers

Ideal for humid and wet environments, the Concerto LED Shower Light family offers a full range of lighting solutions for modern bathrooms, saunas, fitness centers and other light commercial uses. The 4" & 3-1/2" models deliver powerful lighting well suited to high-ceiling applications. With the extensive selection of finishes available for each trim, not to mention the color and output options to choose from, specifiers have an endless palette of luminaires and decorative possibilities at their disposal.

Features

- Shower Lights include a selection of two 4" trims and three 3-1/2" models listed for wet areas
- Flood beam pattern only
- Choice of lenses (Frosted, Clear and Frosted with Clear Center) Ultra-Thin protection clear lens (3 mm) covered with high-performance film (98% light transmission)
- Available color options: 2700K, 3000K, 3500K and 4000K
- Excellent color rendering: 80+ CRI on all models (90+ CRI available in 3000K models)
- Choice of Performance options. Performance 2 trims work with either performance 1 (16W) or Performance 2 (23W) housings.
– See ordering codes for more details
- All models compatible with Remodeler NON-IC, New Construction NON-IC and Classic New Construction IC housings
- Luminaire/Photometric evaluations and listings: cULus, RoHS
- Warranties: 1 year on standard finishes and 5 years on LED modules and drivers



LD3C Low Profile Round Shower Trim

For photometric data, see page 31



LD3CF-15 (Illustrated)

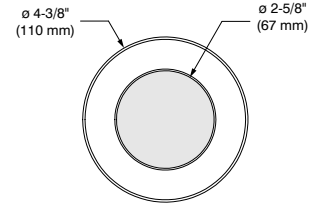
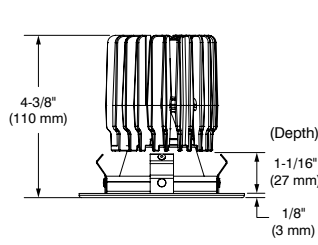

ORDERING CODES

Ex.: LD3CF-064080W2

MODEL	LENS	FINISHES		COLOR TEMPERATURE		CRI		BEAM	PERFORMANCE
LD3C								W	2
LD3C	F Frosted	-01	White	27	2,700K	80	80 + CRI	W Flood (51°)	2
	FC Frosted with clear center	-02	Black	30	3,000K	90	90 + CRI		
		-03	24K Gold Plated	35	3,500K				
	C Clear	-04	Chrome	40	4,000K		Only with 3,000K		
		-04BR	Brushed Chrome						Use with Performance 1 or Performance 2 Housings
		-05	Architectural Bronze						
		-06	Antique Copper						
		-11	Matte White						
		-12BR	Brushed Nickel						
		-13	Satin Nickel						
		-15	Metallic Grey						

LD3H Low Profile Square Shower Trim

For photometric data, see page 32



LD3HF-06 (Illustrated)

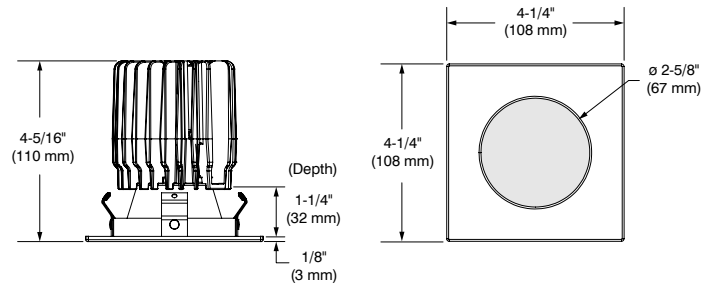

ORDERING CODES

Ex.: LD3HF-112780W2

MODEL	LENS	FINISHES	COLOR TEMPERATURE	CRI	BEAM	PERFORMANCE
LD3H					W	2
LD3H	F Frosted	-01 White	27 2,700K	80 80 + CRI	W Flood (42°)	2
	FC Frosted with clear center	-02 Black	30 3,000K	90 90 + CRI		Use with Performance 1 or Performance 2 Housings
		-03 24K Gold Plated	35 3,500K			
	C Clear	-04 Chrome	40 4,000K	Only with 3,000K		
		-04BR Brushed Chrome				
		-05 Architectural Bronze				
		-06 Antique Copper				
		-11 Matte White				
		-12BR Brushed Nickel				
		-13 Satin Nickel				
		-15 Metallic Grey				

LD3I Low Profile Square Shower Trim with Square Pinhole

For photometric data, see page 32



LD3IF-12BR (Illustrated)

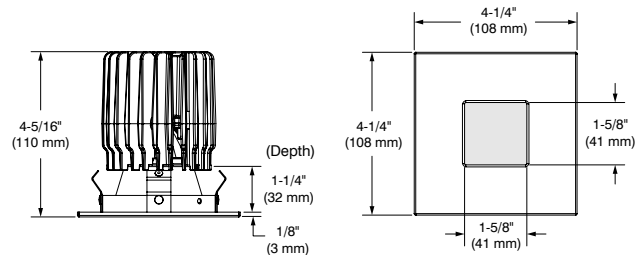

ORDERING CODES

Ex.: LD3IF-153580W2

MODEL	LENS	FINISHES	COLOR TEMPERATURE	CRI	BEAM	PERFORMANCE
LD3I					W	2
LD3I	F Frosted	-01 White	27 2,700K	80 80 + CRI	W Flood (40°)	2
	FC Frosted with clear center	-02 Black	30 3,000K	90 90 + CRI		Use with Performance 1 or Performance 2 Housings
		-03 24K Gold Plated	35 3,500K			
	C Clear	-04 Chrome	40 4,000K	Only with 3,000K		
		-04BR Brushed Chrome				
		-05 Architectural Bronze				
		-06 Antique Copper				
		-11 Matte White				
		-12BR Brushed Nickel				
		-13 Satin Nickel				
		-15 Metallic Grey				

LD2C Low Profile Round Shower Trim

For photometric data, see page 32



LD2CF-04 (Illustrated)

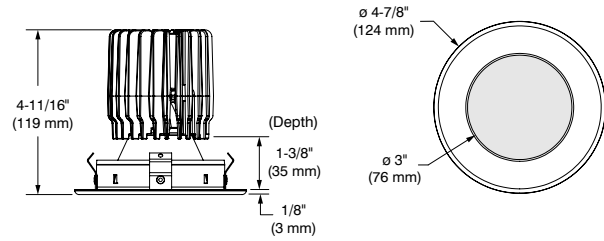

ORDERING CODES

Ex.: LD2CF-053090W2

MODEL	LENS	FINISHES	COLOR TEMPERATURE	CRI	BEAM	PERFORMANCE
LD2C					W	2
LD2C	F Frosted	-01 White	27 2,700K	80 80 + CRI	W Flood (51°)	2
	FC Frosted with clear center	-02 Black	30 3,000K	90 90 + CRI		
		-03 24K Gold Plated	35 3,500K	Only with 3,000K	Use with Performance 1 or Performance 2 Housings	
	C Clear	-04 Chrome	40 4,000K			
		-04BR Brushed Chrome				
		-05 Architectural Bronze				
		-06 Antique Copper				
		-11 Matte White				
		-12BR Brushed Nickel				
		-13 Satin Nickel				
		-15 Metallic Grey				

LD2F Low Profile Square Shower Trim

For photometric data, see page 32



LD2FF-11 (Illustrated)

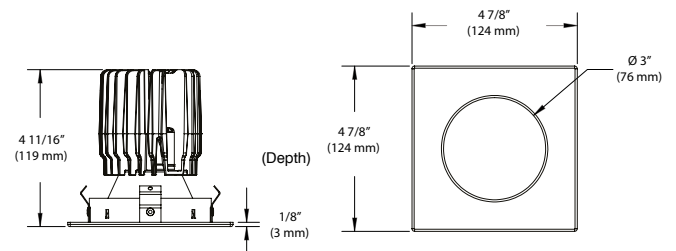

ORDERING CODES

Ex.: LD2FF-013580W2

MODEL	LENS	FINISHES	COLOR TEMPERATURE	CRI	BEAM	PERFORMANCE
LD2F					W	2
LD2F	F Frosted	-01 White	27 2,700K	80 80 + CRI	W Flood (51°)	2
	FC Frosted with clear center	-02 Black	30 3,000K	90 90 + CRI		
		-03 24K Gold Plated	35 3,500K	Only with 3,000K	Use with Performance 1 or Performance 2 Housings	
	C Clear	-04 Chrome	40 4,000K			
		-04BR Brushed Chrome				
		-05 Architectural Bronze				
		-06 Antique Copper				
		-11 Matte White				
		-12BR Brushed Nickel				
		-13 Satin Nickel				
		-15 Metallic Grey				

GOOF RINGS

CONCERTO, for 4" (200) and 3-1/2" (300) series
INTERMEZZO, for 4" (200) series



When the hole cut is larger than necessary or if the gypsum cracked or broke in the surrounding area of the hole, the goof ring will come in handy. You can match them to the color of your trim or ceiling.

	SERIES	CODES	DIMENSIONS	
			Outside diameter	Inside diameter
4"	- 200 series (round trim)	RON2000	Ø 6 ^{1/8"}	Ø 4 ^{1/8"}
3 ^{1/2"}	- 300 series (round trim)	RON3000	Ø 6 ^{1/8"}	Ø 3 ^{5/8"}
			Outside diameter	Inside diameter
4"	- 200 series (square trim)	RON2100	5 ^{1/2"} x 5 ^{1/2"}	Ø 4 ^{1/8"}
3 ^{1/2"}	- 300 series (square trim)	RON3100	5" x 5"	Ø 3 ^{5/8"}

Goof rings are available in all Contraste finishes. Add finish code to the goof ring model.

Ex.: RON2100-12BR

OPENING ADAPTOR

For round trims of 3-1/2" (300) series
(Only Concerto)

Can lip adaptor for 3-1/2" (89 mm) pot in a 4-1/4" (108 mm) opening.

Finish: Galvanized steel (non apparent)

Ordering code: **312296**

DIMENSIONS	
Outside diameter	Inside diameter
Ø 4 ^{5/16"} (110 mm)	Ø 3 ^{5/8"} (92 mm)



LENSES

Show LENSES

Show LENSES		
Frosted (F)	Frosted clear center (FC)	Clear (C)

The linear lens directs the lamp beam to create a strip of light.
The prismatic lens diffuses and spreads the light in an even overall pattern.
The solite lens softens the light in an even overall spread.
The honeycomb lens softens the light glare.

Replacement LENSES (On site modification of the light distribution)

LD3D, LD3E, LD3F, LD3G, LD2J, LD2K			LD3A, LD3B, LD2A, LD2B, LD2D, LD2E		
Clear (C)	47 mm	102958	Clear (C)	49 mm	103584
Frosted (F)	47 mm	313206	Frosted (F)	49 mm	316228
Linear	47 mm	103091	Linear	49 mm	103092
Solite	47 mm	103097	Solite	49 mm	103098
Prismatic	47 mm	103094	Prismatic	49 mm	103095
Honeycomb	49 mm	103089	Honeycomb	49 mm	103089



REFLECTORS FINISHES

Consult trim description for finish options.

ANODIZED



Anodized Aluminum (AN)

PAINTED



*White (-01)



Black (-02)



*Architectural Bronze (-05)



*Antique Copper (-06)



*Matte White (-11)



*Metallic Grey (-15)

*These reflector colors are available only with the same trim color.

SPECULAR



Specular (SP)



Clear (CL)



Black (BK)

CONCERTO REPLACEMENT OPTIC REFLECTORS

(On site beam angle modification)

Adjustable Trims			Downlight Trims		
MODELS	(M) Narrow Flood (27°) 316082	(W) Flood (48°) 316211	MODELS	(M) Narrow Flood (33°) 316082	(W) Flood (48°) 316083
LD3A	X	X	LD3D	X	X
LD3B	X	X	LD2J	X	X
LD2A	X	X	LD2K	X	X
LD2B	X	X			
LD2D	X	X			
LD2E	X	X			

INTERMEZZO

Reflectors are painted black for a discrete look in your ceiling.
No replacement optic reflectors available.

PLATES AND MOUNTING BARS FOR "NON-IC" TYPE HOUSINGS

The mounting plates and mounting bars are used to facilitate the installation of the recessed fixture.

Mounting Plates

Mounting bars required

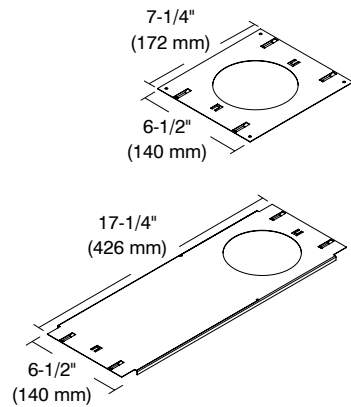

Model	Ceiling Cutout
P2000	∅ 4 ^{3/16"} (106 mm)
P2550/P3600	∅ 3 ^{3/4"} (96 mm)

Model	Ceiling Cutout
P2000L	∅ 4 ^{1/4"} (108 mm)
P2550L	∅ 3 ^{3/4"} (96 mm)

Adjustable Mounting Bars

Choose the mounting bars according to the distance in between the joists.

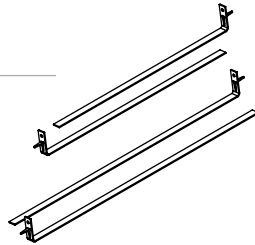

Short Bars Adjustable - 2 units	
BARS	From 13 ^{1/2"} to 21 ^{3/4"} (343 mm to 553 mm)

Long Bars Adjustable - 2 units	
BARL	From 19 ^{1/2"} to 34" ¹ (495 mm to 863 mm)

Mounting Plates

Mounting bars NOT required

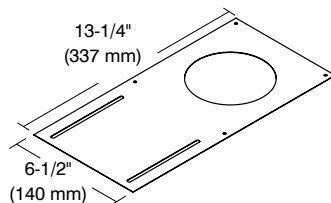

Model	Ceiling Cutout
P2000N	∅ 4 ^{1/4"} (108 mm)
P2550N/P3600N	∅ 3 ^{3/4"} (96 mm)

New Construction Mounting Plates

Mounting bars INCLUDED

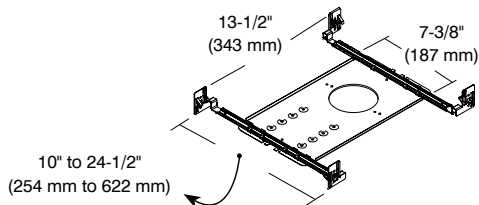

Model	Ceiling Cutout
P2000NW	∅ 4 ^{1/16"} (103 mm)
P2550NW	∅ 3 ^{9/16"} (90 mm)

New Construction Mounting Bars

Same as used in "NW" housings

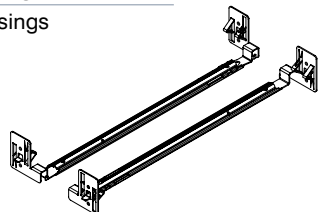

Interlocking Bars Adjustable - 2 units	
BARK	From 10" to 24 ^{1/2"} (254 mm to 622 mm)

Photometric Data

PHOTOMETRIC DATA

The following section include examples of some photometric data. For complete offering of .IES files, please consult Contraste website at www.contrastlighting.com.



Photometric Data

3,000K 80+ CRI

LD3D Low Profile Round Regressed Trim

3,000K, 80 + of CRI, Flood with performance 1 housing

CANDLEPOWER DISTRIBUTION

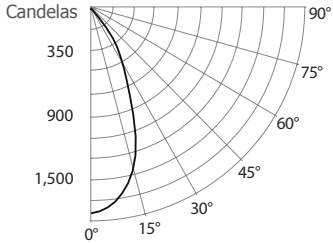

LIGHT CONE

Distance	FC	DIA
06'	47.8	5.1'
08'	26.9	6.8'
10'	17.2	8.5'
12'	12.0	10.2'
14'	8.8	11.9'
16'	6.7	13.5'

Beam: 46°
Beam Edge defined as 50% of Maximum Nadir Candle-power.

LUMINAIRE

Performance 1 LED	3,000K Flood	
CBCP / Lumens	1,722	/ 1,056
Watts	120V	277V
	16.1W	16.6W
Operating AMPS	0.19A	0.059A
Lumen Maintenance	L70 @ 50,000 Hrs	
CRI	80 +	
Lumens/Watt	66	
Spacing Criteria	0.7	
Certificate LM79-08	Based on test 475906	

COEFFICIENT OF UTILIZATION - %

Ceiling Reflect %	80		50		30		
Wall Reflect %	50	30	50	30	50	30	
RCR	0	119	119	111	111	106	106
	2	104	100	99	96	96	94
	4	92	87	89	85	87	83
	6	82	77	80	76	79	75
	8	74	69	73	68	72	68
	10	68	62	66	62	66	61

Zonal Cavity Method

Effective Floor Cavity Reflectance 20%

LD3D Low Profile Round Regressed Trim

3,000K, 80 + of CRI, Narrow Flood with performance 2 housing

CANDLEPOWER DISTRIBUTION

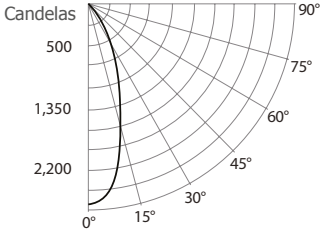

LIGHT CONE

Distance	FC	DIA
06'	72.4	3.8'
08'	40.7	5.1'
10'	26.1	6.4'
12'	18.1	7.7'
14'	13.3	9.0'
16'	10.2	10.2'

Beam: 35°
Beam Edge defined as 50% of Maximum Nadir Candle-power.

LUMINAIRE

Performance 2 LED	3,000K Narrow Flood	
CBCP / Lumens	2,607	/ 1,278
Watts	120V	277V
	21.5W	22W
Operating AMPS	0.18A	0.079A
Lumen Maintenance	L70 @ 50,000 Hrs	
CRI	80 +	
Lumens/Watt	59	
Spacing Criteria	0.6	
Certificate LM79-08	Based on test 475903	

COEFFICIENT OF UTILIZATION - %

Ceiling Reflect %	80		50		30		
Wall Reflect %	50	30	50	30	50	30	
RCR	0	119	119	111	111	106	106
	2	104	101	99	97	96	94
	4	93	88	89	85	88	84
	6	83	78	81	77	80	76
	8	75	70	74	69	73	69
	10	69	64	68	63	67	63

Zonal Cavity Method

Effective Floor Cavity Reflectance 20%

LD3D Low Profile Round Regressed Trim

3,000K, 80 + of CRI, Flood with performance 3 housing

CANDLEPOWER DISTRIBUTION

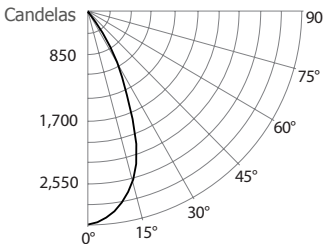

LIGHT CONE

Distance	FC	DIA
06'	83.8	5.2'
08'	47.1	7.0'
10'	30.2	8.7'
12'	20.9	10.4'
14'	15.4	12.2'
16'	11.8	13.9'

Beam: 47°
Beam Edge defined as 50% of Maximum Nadir Candle-power.

LUMINAIRE

Performance 3 LED	3,000K Flood	
CBCP / Lumens	3,016	/ 1,842
Watts	120V	277V
	29.28W	29.78W
Operating AMPS	0.25A	0.107A
Lumen Maintenance	L70 @ 50,000 Hrs	
CRI	80 +	
Lumens/Watt	62.9	
Spacing Criteria	0.7	
Certificate LM79-08	607004	

COEFFICIENT OF UTILIZATION - %

Ceiling Reflect %	80		50		30		
Wall Reflect %	50	30	50	30	50	30	
RCR	0	119	119	111	111	106	106
	2	107	104	102	100	99	98
	4	98	94	95	92	94	91
	6	91	87	89	86	88	85
	8	84	80	83	79	82	78
	10	78	74	77	73	76	73

Zonal Cavity Method

Effective Floor Cavity Reflectance 20%

LD3E Low Profile Round Regressed Trim with Lipped Reflector

3,000K, 80 + of CRI, Spot with performance 3 housing

CANDLEPOWER DISTRIBUTION

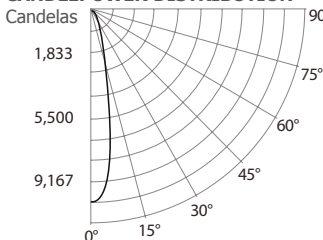

LIGHT CONE

Distance	FC	DIA
06'	278.7	2.2'
08'	156.8	2.9'
10'	100.3	3.7'
12'	69.7	4.4'
14'	51.2	5.2'
16'	39.2	5.9'

Beam: 21°
Beam Edge defined as 50% of Maximum Nadir Candle-power.

LUMINAIRE

Performance 3 LED	3,000K Spot	
CBCP / Lumens	10,034	/ 2,282
Watts	120V	277V
	30.58W	31.08W
Operating AMPS	0.25A	0.112A
Lumen Maintenance	L70 @ 50,000 Hrs	
CRI	80 +	
Lumens/Watt	74.3	
Spacing Criteria	0.4	
Certificate LM79-08	S1405264-R1	

COEFFICIENT OF UTILIZATION - %

Ceiling Reflect %	80		50		30		
Wall Reflect %	50	30	50	30	50	30	
RCR	0	119	119	111	111	106	106
	2	106	102	101	98	98	96
	4	95	91	92	89	90	87
	6	87	83	85	81	84	80
	8	81	76	79	75	78	75
	10	75	71	74	70	74	70

Zonal Cavity Method

Effective Floor Cavity Reflectance 20%

Photometric Data

3,000K 80+ CRI

LD3F Square Regressed Low Profile Trim with Lipped Reflector

3,000K, 80 + of CRI, Narrow Flood with performance 3 housing

CANDLEPOWER DISTRIBUTION

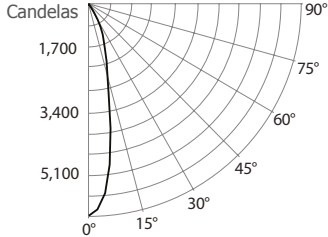

LIGHT CONE

Distance	FC	DIA
06'	167.5	2.5'
08'	94.2	3.3'
10'	60.3	4.1'
12'	41.9	4.9'
14'	30.8	5.7'
16'	23.6	6.5'

Beam: 23°
Beam Edge defined as 50% of Maximum Nadir Candle-power.

LUMINAIRE

Performance 3 LED	3,000K	Narrow Flood
CBCP / Lumens	6,029	/ 1,620
Watts	120V	277V
	29.24W	29.74W
Operating AMPS	0.24A	0.107A
Lumen Maintenance	L70 @ 50,000 Hrs	
CRI	80 +	
Lumens/Watt	55.5	
Spacing Criteria	0.4	
Certificate LM79-08	607000	

COEFFICIENT OF UTILIZATION - %

Ceiling Reflect %	80			50			30		
Wall Reflect %	50	30	50	30	50	30	50	30	
RCR	0	119	119	111	111	106	106	106	
	2	109	106	104	102	101	101	100	
	4	101	98	98	96	97	94	94	
	6	95	92	93	90	92	90	90	
	8	90	86	88	85	87	85	85	
	10	85	81	84	81	83	80	80	

Zonal Cavity Method
Effective Floor Cavity Reflectance 20%

LD3G Square Regressed Low Profile Trim with Square Pinhole

3,000K, 80 + of CRI, Narrow Flood with performance 2 housing

CANDLEPOWER DISTRIBUTION

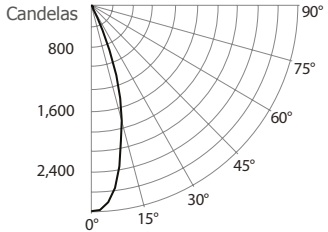

LIGHT CONE

Distance	FC	DIA
06'	80.1	3.6'
08'	45.0	4.8'
10'	28.8	5.9'
12'	20.0	7.1'
14'	14.7	8.3'
16'	11.3	9.5'

Beam: 33°
Beam Edge defined as 50% of Maximum Nadir Candle-power.

LUMINAIRE

Performance 2 LED	3,000K	Narrow Flood
CBCP / Lumens	2,883	/ 1,024
Watts	120V	277V
	22.50W	23W
Operating AMPS	0.18A	0.083A
Lumen Maintenance	L70 @ 50,000 Hrs	
CRI	80 +	
Lumens/Watt	46	
Spacing Criteria	0.5	
Certificate LM79-08	475893	

COEFFICIENT OF UTILIZATION - %

Ceiling Reflect %	80			50			30		
Wall Reflect %	50	30	50	30	50	30	50	30	
RCR	0	119	119	111	111	106	106	106	
	2	108	105	103	101	100	99	99	
	4	100	97	97	94	95	93	93	
	6	94	90	92	89	91	88	88	
	8	88	85	87	84	86	83	83	
	10	84	80	83	79	82	79	79	

Zonal Cavity Method
Effective Floor Cavity Reflectance 20%

LD2J Low Profile Round Regressed Trim

3,000K, 80 + of CRI, Flood with performance 2 housing

CANDLEPOWER DISTRIBUTION

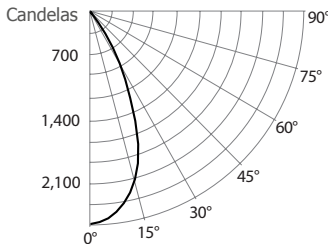

LIGHT CONE

Distance	FC	DIA
06'	60.8	5.3'
08'	34.2	7.1'
10'	21.9	8.8'
12'	15.2	10.6'
14'	11.2	12.4'
16'	8.5	14.1'

Beam: 48°
Beam Edge defined as 50% of Maximum Nadir Candle-power.

LUMINAIRE

Performance 2 LED	3,000K	Flood
CBCP / Lumens	2,187	/ 1,370
Watts	120V	277V
	21.5W	22W
Operating AMPS	0.18A	0.079A
Lumen Maintenance	L70 @ 50,000 Hrs	
CRI	80 +	
Lumens/Watt	63.4	
Spacing Criteria	0.7	
Certificate LM79-08	Based on test 475915	

COEFFICIENT OF UTILIZATION - %

Ceiling Reflect %	80			50			30		
Wall Reflect %	50	30	50	30	50	30	50	30	
RCR	0	119	119	111	111	106	106	106	
	2	107	104	102	100	99	97	97	
	4	98	94	95	92	93	90	90	
	6	90	86	88	85	87	84	84	
	8	83	79	82	78	81	78	78	
	10	77	73	76	72	76	72	72	

Zonal Cavity Method
Effective Floor Cavity Reflectance 20%

LD2K Low Profile Square Regressed Trim

3,000K, 80 + of CRI, Narrow Flood with performance 3 housing

CANDLEPOWER DISTRIBUTION

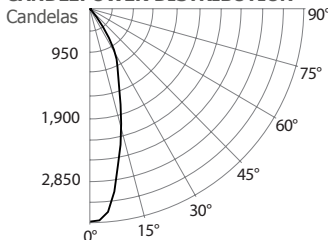

LIGHT CONE

Distance	FC	DIA
06'	94.7	3.6'
08'	53.3	4.8'
10'	34.1	6.0'
12'	23.7	7.2'
14'	17.4	8.4'
16'	13.3	9.6'

Beam: 33°
Beam Edge defined as 50% of Maximum Nadir Candle-power.

LUMINAIRE

Performance 3 LED	3,000K	Narrow Flood
CBCP / Lumens	3,409	/ 1,566
Watts	120V	277V
	29.2W	29.7W
Operating AMPS	0.24A	0.107A
Lumen Maintenance	L70 @ 50,000 Hrs	
CRI	80 +	
Lumens/Watt	53.6	
Spacing Criteria	0.5	
Certificate LM79-08	Based on test 607002	

COEFFICIENT OF UTILIZATION - %

Ceiling Reflect %	80			50			30		
Wall Reflect %	50	30	50	30	50	30	50	30	
RCR	0	119	119	111	111	106	106	106	
	2	107	104	102	100	99	98	98	
	4	98	94	95	92	93	90	90	
	6	91	86	88	85	87	84	84	
	8	84	79	82	78	81	78	78	
	10	77	73	76	72	76	72	72	

Zonal Cavity Method
Effective Floor Cavity Reflectance 20%

Photometric Data

3,000K 80+ CRI

LD3A Low Profile Round Adjustable Trim

3,000K, 80 + of CRI, Narrow Flood with performance 2 housing

CANDLEPOWER DISTRIBUTION

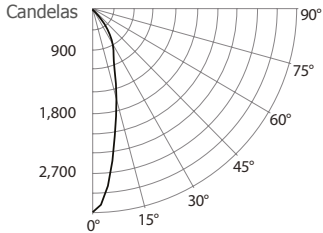

LIGHT CONE

Distance	FC	DIA
06'	88.9	2.9'
08'	50.0	3.9'
10'	32.0	4.9'
12'	22.2	5.8'
14'	16.3	6.8'
16'	12.5	7.8'

Beam: 27°
Beam Edge defined as 50% of Maximum Nadir Candle-power.

LUMINAIRE

Performance 2 LED	3,000K	Narrow Flood
CBCP / Lumens	3,200	/ 1,435
Watts	120V	277V
	23.2W	23.7W
Operating AMPS	0.13A	0.060A
Lumen Maintenance	L70 @ 50,000 Hrs	
CRI	80 +	
Lumens/Watt	61.8	
Spacing Criteria	0.4	
Certificate LM79-08	Based on test 606976	

COEFFICIENT OF UTILIZATION - %

Ceiling Reflect %	80	50	30				
Wall Reflect %	50	30	50	30	50	30	
RCR	0	119	119	111	111	106	106
	2	106	103	101	99	98	96
	4	96	91	92	89	90	87
	6	87	81	84	80	83	79
	8	78	73	76	72	76	72
	10	71	66	69	65	69	65

Zonal Cavity Method

Effective Floor Cavity Reflectance 20%

LD3B Low Profile Square Adjustable Trim

3,000K, 80 + of CRI, Flood with performance 2 housing

CANDLEPOWER DISTRIBUTION

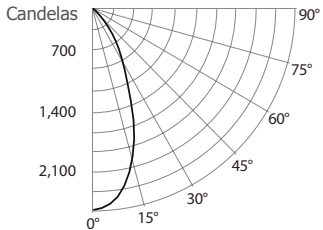

LIGHT CONE

Distance	FC	DIA
06'	66.3	4.9'
08'	37.3	6.5'
10'	23.9	8.2'
12'	16.6	9.8'
14'	12.2	11.5'
16'	9.3	13.1'

Beam: 45°
Beam Edge defined as 50% of Maximum Nadir Candle-power.

LUMINAIRE

Performance 2 LED	3,000K	Flood
CBCP / Lumens	2,387	/ 1,569
Watts	120V	277V
	23.15W	23.65W
Operating AMPS	0.19A	0.085A
Lumen Maintenance	L70 @ 50,000 Hrs	
CRI	80 +	
Lumens/Watt	67.9	
Spacing Criteria	0.7	
Certificate LM79-08	Based on test 606978	

COEFFICIENT OF UTILIZATION - %

Ceiling Reflect %	80	50	30				
Wall Reflect %	50	30	50	30	50	30	
RCR	0	119	119	111	111	106	106
	2	106	103	101	99	99	97
	4	96	92	93	90	91	88
	6	88	83	85	82	84	81
	8	79	75	78	74	77	73
	10	72	67	71	67	70	66

Zonal Cavity Method

Effective Floor Cavity Reflectance 20%

LD2A Low Profile Round Adjustable Trim

3,000K, 80 + of CRI, Narrow Flood with performance 1 housing

CANDLEPOWER DISTRIBUTION

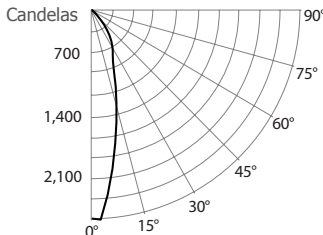

LIGHT CONE

Distance	FC	DIA
06'	68.2	3.0'
08'	38.4	4.0'
10'	24.6	5.0'
12'	17.1	5.9'
14'	12.5	6.9'
16'	9.6	7.9'

Beam: 28°
Beam Edge defined as 50% of Maximum Nadir Candle-power.

LUMINAIRE

Performance 1 LED	3,000K	Narrow Flood
CBCP / Lumens	2,456	/ 1,094
Watts	120V	277V
	16.16W	16.66W
Operating AMPS	0.13A	0.060A
Lumen Maintenance	L70 @ 50,000 Hrs	
CRI	80 +	
Lumens/Watt	67.5	
Spacing Criteria	0.5	
Certificate LM79-08	475821	

COEFFICIENT OF UTILIZATION - %

Ceiling Reflect %	80	50	30				
Wall Reflect %	50	30	50	30	50	30	
RCR	0	119	119	111	111	106	106
	2	106	103	101	99	98	96
	4	96	91	93	89	91	88
	6	87	82	85	81	83	80
	8	78	74	77	73	76	72
	10	71	66	70	66	69	65

Zonal Cavity Method

Effective Floor Cavity Reflectance 20%

LD2B Low Profile Square Adjustable Trim

3,000K, 80 + of CRI, Flood with performance 1 housing

CANDLEPOWER DISTRIBUTION

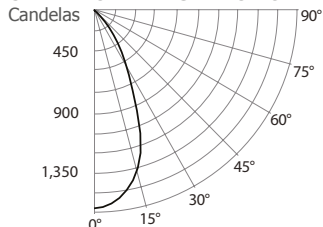

LIGHT CONE

Distance	FC	DIA
06'	43.3	5.3'
08'	24.3	7.0'
10'	15.6	8.8'
12'	10.8	10.5'
14'	7.9	12.3'
16'	6.1	14.1'

Beam: 47°
Beam Edge defined as 50% of Maximum Nadir Candle-power.

LUMINAIRE

Performance 1 LED	3,000K	Flood
CBCP / Lumens	1,558	/ 1,088
Watts	120V	277V
	15.53W	16.03W
Operating AMPS	0.19A	0.058A
Lumen Maintenance	L70 @ 50,000 Hrs	
CRI	80 +	
Lumens/Watt	70.2	
Spacing Criteria	0.7	
Certificate LM79-08	Based on test 475823	

COEFFICIENT OF UTILIZATION - %

Ceiling Reflect %	80	50	30				
Wall Reflect %	50	30	50	30	50	30	
RCR	0	119	119	111	111	106	106
	2	106	103	101	99	99	97
	4	97	92	93	90	92	89
	6	88	83	86	82	84	81
	8	80	75	78	74	77	74
	10	73	68	71	67	71	67

Zonal Cavity Method

Effective Floor Cavity Reflectance 20%

Photometric Data

3,000K 80+ CRI

LD2D Low Profile Round Adjustable Regressed Trim

3,000K, 80 + of CRI, Flood with performance 1 housing

CANDLEPOWER DISTRIBUTION

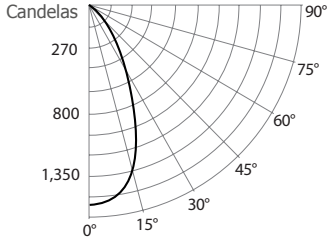

LIGHT CONE

Distance	FC	DIA
06'	42.1	5.3
08'	23.7	7.1
10'	15.2	8.9
12'	10.5	10.7
14'	7.7	12.5
16'	5.9	14.3

Beam: 48°
Beam Edge defined as 50% of Maximum Nadir Candle-power.

LUMINAIRE

Performance 1 LED	3,000K Flood
CBCP / Lumens	1,515 / 1,062
Watts	120V 277V 15.5W 16W
Operating AMPS	0.13A 0.057A
Lumen Maintenance	L70 @ 50,000 Hrs
CRI	80+
Lumens/Watt	69
Spacing Criteria	0.8
Certificate LM79-08	475809

COEFFICIENT OF UTILIZATION - %

Ceiling Reflect %	80			50			30		
Wall Reflect %	50	30	50	30	50	30	50	30	
RCR	0	119	119	111	111	106	106	106	
	2	107	104	102	99	99	97	97	
	4	97	93	94	90	92	89	89	
	6	88	84	86	82	85	82	82	
	8	80	76	79	75	78	74	74	
	10	73	69	72	68	71	68	68	

Zonal Cavity Method

Effective Floor Cavity Reflectance 20%

LD2D Low Profile Round Adjustable Regressed Trim

3,000K, 80 + of CRI, Narrow Flood with performance 2 housing

CANDLEPOWER DISTRIBUTION

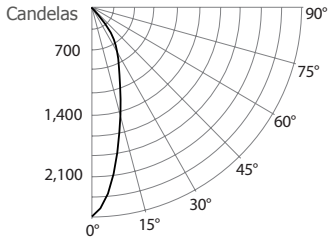

LIGHT CONE

Distance	FC	DIA
06'	68.6	3.5'
08'	38.6	4.6'
10'	24.7	5.8'
12'	17.2	6.9'
14'	12.6	8.1'
16'	9.7	9.2'

Beam: 32°
Beam Edge defined as 50% of Maximum Nadir Candle-power.

LUMINAIRE

Performance 2 LED	3,000K Narrow Flood
CBCP / Lumens	2,471 / 1,247
Watts	120V 277V 23.1W 23.6W
Operating AMPS	0.19A 0.085A
Lumen Maintenance	L70 @ 50,000 Hrs
CRI	80+
Lumens/Watt	54
Spacing Criteria	0.5
Certificate LM79-08	606972

COEFFICIENT OF UTILIZATION - %

Ceiling Reflect %	80			50			30		
Wall Reflect %	50	30	50	30	50	30	50	30	
RCR	0	119	119	111	111	106	106	106	
	2	107	103	101	99	99	97	97	
	4	96	92	93	90	91	89	89	
	6	88	83	86	82	84	81	81	
	8	79	75	78	74	77	73	73	
	10	72	67	71	67	70	66	66	

Zonal Cavity Method

Effective Floor Cavity Reflectance 20%

LD2E Low Profile Square Adjustable Regressed Trim

3,000K, 80 + of CRI, Flood with performance 2 housing

CANDLEPOWER DISTRIBUTION

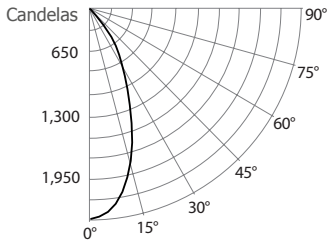

LIGHT CONE

Distance	FC	DIA
06'	64.6	4.9'
08'	36.3	6.6'
10'	23.2	8.2'
12'	16.1	9.9'
14'	11.9	11.5'
16'	9.1	13.2'

Beam: 45°
Beam Edge defined as 50% of Maximum Nadir Candle-power.

LUMINAIRE

Performance 2 LED	3,000K Flood
CBCP / Lumens	2,324 / 1,484
Watts	23W 23.5W
Operating AMPS	0.19A 0.084A
Lumen Maintenance	L70 @ 50,000 Hrs
CRI	80+
Lumens/Watt	64
Spacing Criteria	0.7
Certificate LM79-08	Based on test 606974

COEFFICIENT OF UTILIZATION - %

Ceiling Reflect %	80			50			30		
Wall Reflect %	50	30	50	30	50	30	50	30	
RCR	0	119	119	111	111	106	106	106	
	2	107	104	102	100	99	97	97	
	4	97	93	94	91	92	89	89	
	6	89	84	87	83	85	82	82	
	8	81	76	79	75	78	75	75	
	10	74	69	72	68	72	68	68	

Zonal Cavity Method

Effective Floor Cavity Reflectance 20%

LD3C Low Profile Round Shower Trim

3,000K, 80 + of CRI, Flood with performance 2 housing

CANDLEPOWER DISTRIBUTION

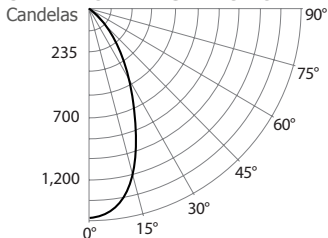

LIGHT CONE

Distance	FC	DIA
06'	38.1	5.7'
08'	21.4	7.6'
10'	13.7	9.5'
12'	9.5	11.4'
14'	7.0	13.4'
16'	5.4	15.3'

Beam: 51°
Beam Edge defined as 50% of Maximum Nadir Candle-power.

LUMINAIRE

Performance 2 LED	3,000K Flood
CBCP / Lumens	1,370 / 1,204
Watts	120V 277V 22.6W 23.1W
Operating AMPS	0.19A 0.083A
Lumen Maintenance	L70 @ 50,000 Hrs
CRI	80+
Lumens/Watt	53
Spacing Criteria	0.8
Certificate LM79-08	Base on test 475837

COEFFICIENT OF UTILIZATION - %

Ceiling Reflect %	80			50			30		
Wall Reflect %	50	30	50	30	50	30	50	30	
RCR	0	119	119	111	111	106	106	106	
	2	100	95	95	91	92	89	89	
	4	85	79	82	77	80	76	76	
	6	74	68	72	66	70	65	65	
	8	65	59	64	58	62	57	57	
	10	58	52	57	51	56	51	51	

Zonal Cavity Method

Effective Floor Cavity Reflectance 20%

Photometric Data

3,000K 80+ CRI

LD3H Low Profile Square Shower Trim

3,000K, 80 + CRI, Flood with performance 1 housing

CANDLEPOWER DISTRIBUTION

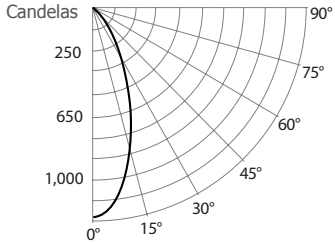

LIGHT CONE

Distance	FC	DIA
06'	35.2	4.6'
08'	19.8	6.1'
10'	12.7	7.6'
12'	8.8	9.1'
14'	6.5	10.7'
16'	5.0	12.2'

Beam: 42°
Beam Edge defined as 50% of Maximum Nadir Candle-power.

LUMINAIRE

Performance 1 LED	3,000K Flood
CBCP / Lumens	1,268 / 866
Watts	120V 277V 15.7W 16.2W
Operating AMPS	0.13A 0.058A
Lumen Maintenance	L70 @ 50,000 Hrs
CRI	80 +
Lumens/Watt	55
Spacing Criteria	0.7
Certificate LM79-08	475927

COEFFICIENT OF UTILIZATION - %

Ceiling Reflect %	80		50		30		
Wall Reflect %	50	30	50	30	50	30	
RCR	0	119	119	111	111	106	106
	2	104	100	98	96	96	93
	4	92	87	88	84	86	83
	6	82	76	80	75	78	74
	8	73	68	72	67	71	66
	10	66	61	65	60	64	60

Zonal Cavity Method

Effective Floor Cavity Reflectance 20%

LD3I Low Profile Square Shower Trim with Square Pinhole

3,000K, 80 + CRI, Flood with performance 2 housing

CANDLEPOWER DISTRIBUTION

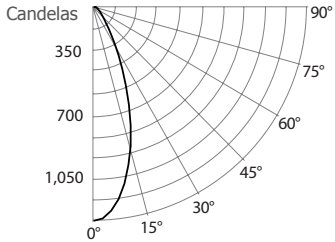

LIGHT CONE

Distance	FC	DIA
06'	33.8	4.3'
08'	19.0	5.8'
10'	12.2	7.2'
12'	8.5	8.6'
14'	6.2	10.1'
16'	4.8	11.5'

Beam: 40°
Beam Edge defined as 50% of Maximum Nadir Candle-power.

LUMINAIRE

Performance 2 LED	3,000K Flood
CBCP / Lumens	1,218 / 757
Watts	120V 277V 21.5W 22W
Operating AMPS	0.18A 0.079
Lumen Maintenance	L70 @ 50,000 Hrs
CRI	80 +
Lumens/Watt	35.5
Spacing Criteria	0.6
Certificate LM79-08	475949

COEFFICIENT OF UTILIZATION - %

Ceiling Reflect %	80		50		30		
Wall Reflect %	50	30	50	30	50	30	
RCR	0	119	119	111	111	106	106
	2	103	100	98	96	96	93
	4	92	87	89	84	87	83
	6	82	77	80	76	79	75
	8	74	69	73	68	72	67
	10	68	62	66	62	66	61

Zonal Cavity Method

Effective Floor Cavity Reflectance 20%

LD2C Low Profile Round Shower Trim

3,000K, 80 + of CRI, Flood with performance 1 housing

CANDLEPOWER DISTRIBUTION

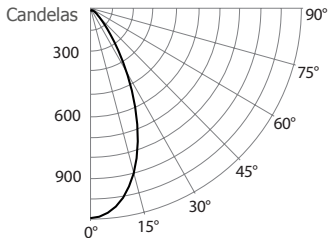

LIGHT CONE

Distance	FC	DIA
06'	27.2	5.7'
08'	15.3	7.6'
10'	9.8	9.5'
12'	6.8	11.4'
14'	5.0	13.3'
16'	3.8	15.2'

Beam: 51°
Beam Edge defined as 50% of Maximum Nadir Candle-power.

LUMINAIRE

Performance 1 LED	3,000K Flood
CBCP / Lumens	979 / 859
Watts	120V 277V 15.59W 16.09W
Operating AMPS	0.13A 0.058A
Lumen Maintenance	L70 @ 50,000 Hrs
CRI	80 +
Lumens/Watt	55
Spacing Criteria	0.8
Certificate LM79-08	475837

COEFFICIENT OF UTILIZATION - %

Ceiling Reflect %	80		50		30		
Wall Reflect %	50	30	50	30	50	30	
RCR	0	119	119	111	111	106	106
	2	103	99	98	95	95	92
	4	90	85	87	83	85	81
	6	80	74	78	73	76	72
	8	71	65	69	64	68	64
	10	64	58	62	57	62	57

Zonal Cavity Method

Effective Floor Cavity Reflectance 20%

LD2F Low Profile Square Shower Trim

3,000K, 80 + of CRI, Flood with performance 2 housing

CANDLEPOWER DISTRIBUTION

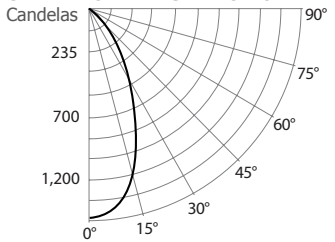

LIGHT CONE

Distance	FC	DIA
06'	38.1	5.7'
08'	21.4	7.6'
10'	13.7	9.5'
12'	9.5	11.4'
14'	7.0	13.4'
16'	5.4	15.3'

Beam: 51°
Beam Edge defined as 50% of Maximum Nadir Candle-power.

LUMINAIRE

Performance 2 LED	3,000K Flood
CBCP / Lumens	1,370 / 1,204
Watts	120V 277V 15.6W 16.1W
Operating AMPS	0.19A 0.058A
Lumen Maintenance	L70 @ 50,000 Hrs
CRI	80 +
Lumens/Watt	53
Spacing Criteria	0.8
Certificate LM79-08	Base on test 475837

COEFFICIENT OF UTILIZATION - %

Ceiling Reflect %	80		50		30		
Wall Reflect %	50	30	50	30	50	30	
RCR	0	119	119	111	111	106	106
	2	100	95	95	91	92	89
	4	85	79	82	77	80	76
	6	74	68	72	66	70	65
	8	65	59	64	58	62	57
	10	58	52	57	51	56	51

Zonal Cavity Method

Effective Floor Cavity Reflectance 20%





Corporate Headquarters

1009, rue du Parc Industriel
Saint-Jean-Chrysostome (Québec) G6Z 1C5 Canada

Phone: 418 839-4624 Toll free: 1 888 839-4624
Fax: 418 839-7057 Toll free: 1 877 839-7057

info@contrastlighting.com
www.contrastlighting.com

© 2019 Contrast Lighting Inc.
All rights reserved. Printed in Canada.

Contrast Lighting reserves the right to make changes in specifications and/or to discontinue any product at any time without notice or obligation and will not be liable for any consequences resulting from the use of this publication.

403464 To view the latest version of this catalog, please visit the "Documentation" section of the Contrast website at <http://contrastlighting.com/>.

